

# \$1,650,000 - 1016 Bull Crescent, Kelowna

MLS® #10356307

**\$1,650,000**

5 Bedroom, 5.00 Bathroom, 3,530 sqft

Single Family on 0.16 Acres

Lower Mission, Kelowna, British Columbia

Nestled in the heart of Kelowna's most desirable neighbourhoods, The Orchard in the Lower Mission offers a rare blend of luxury living, community charm, and everyday convenience. Built on the land of a former working orchard, this thoughtfully planned community features modern custom homes surrounded by agricultural green space, scenic mountain views, and easy access to some of the Okanagan's finest amenities. The area is a culinary and recreational jackpot: lakeside restaurants, vibrant patios, local vineyards and breweries are just a short hop away. From the moment you arrive, The Orchard captures the essence of the Lower Mission lifestyle.

Families are drawn to the top-rated schools within walking distance, including Anne McClymont Elementary and Okanagan Mission Secondary. For active lifestyles, the community is just minutes from Sarsons Beach and the Mission Greenway. This contemporary luxury home is ready to be built to your exact specifications. 1016 Bull Cres is planned as a six-bedroom high-end home with an office, den and included is a full separate access one-bedroom, one-bathroom suite. An attached garage as well as basement area allow for ample storage. Plans feature a basement recreation room, main floor living area and second floor den, allowing for relaxation and recreation. Don't miss your opportunity to choose your ideal finishes and customize your modern dream home in The Orchard. Expected completion is Summer

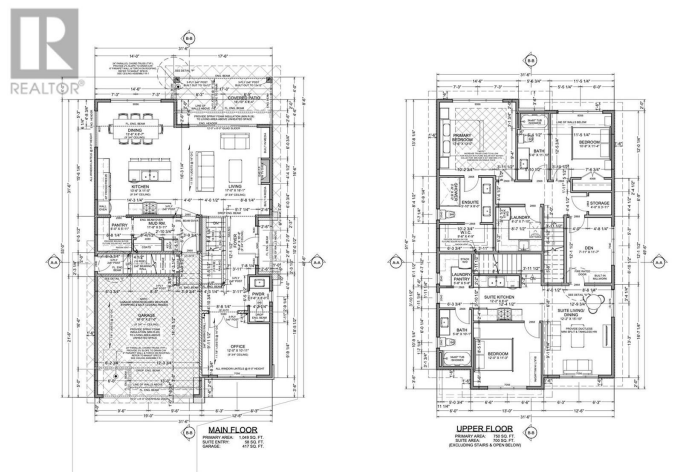

\*NOTES\*  
CONTRACTOR TO CONFIRM  
DIMENSIONS TO OWNER

Built in 2026

**Essential Information**

Listing #	10356307
Price	\$1,650,000
Bedrooms	5
Bathrooms	5.00
Half Baths	1
Square Footage	3,530
Acres	0.16
Year Built	2026
Type	Single Family
Sub-Type	Freehold
Style	Contemporary

**Community Information**

Address	1016 Bull Crescent
Subdivision	Lower Mission
City	Kelowna
Province	British Columbia
Postal Code	V1W0B6

**Amenities**

Features	Central island
Parking Spaces	4
Parking	Attached Garage
# of Garages	2

**Interior**

Heating	Forced air
Cooling	Central air conditioning
Fireplace	Yes
# of Fireplaces	2
# of Stories	2

**Exterior**

Exterior	Aluminum, Stone, Stucco
----------	-------------------------

Roof                      Asphalt shingle

### **Additional Information**

Zoning                      Single family dwelling

### **Listing Details**

Listing Office              Sotheby's International Realty Canada



The trademarks MLS®, Multiple Listing Service® and the associated logos are owned by The Canadian Real Estate Association (CREA) and identify the quality of services provided by real estate professionals who are members of CREA. REALTOR®. Member of CREA and more.

Listing information last updated on October 14th, 2025 at 8:31am CDT