

\$ - 1112, 20 Dawson Wharf Mount, Chestermere

MLS® #A2258671

\$

0 Bedroom, 0.00 Bathroom, 1,119 sqft

Retail

Dawson's Landing, Chestermere, Alberta

An exclusive and rare main floor retail unit of approximately 1,119 sq. ft. is now available for lease in one of Chestermere's most sought-after plazas, located in the growing community of Dawson's Landing. This unit offers excellent visibility, easy accessibility, and is surrounded by a dynamic mix of businesses and professional services including Chestermere Law, The Chai Bar, Sixty Wings, RE/MAX Keys, Jerry's Smoke & Vape Shop, and more driving consistent foot traffic to the plaza. This versatile unit is an excellent fit for a wide range of businesses, including a doggy daycare, veterinary clinic, sandwich franchise, burrito franchise, shawarma, or other retail/professional services. With strong visibility, easy access, and a thriving surrounding community, the possibilities are endless. With its modern design, massive parking lot, and prime location within a residential and commercial corridor, this unit is an exceptional opportunity for a wide variety of retail or professional service uses! (id:6289)

Built in 2024

Essential Information

Listing #	A2258671
Bathrooms	0.00
Square Footage	1,119
Year Built	2024
Type	Retail

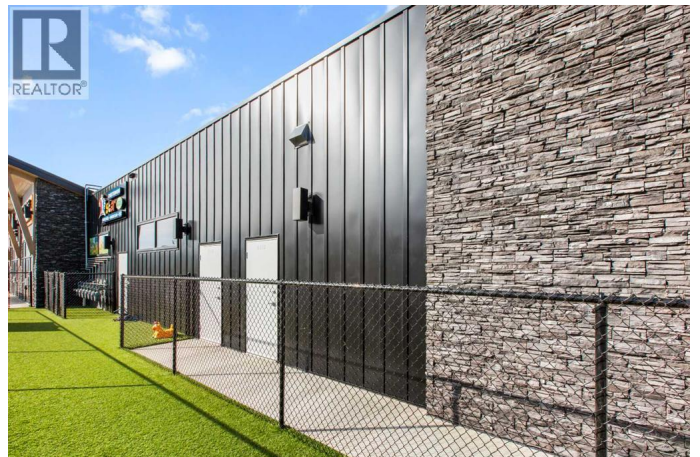
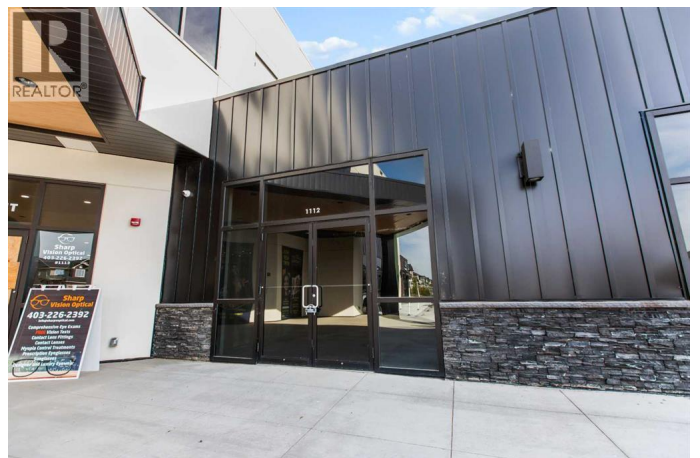

Community Information

Address 1112, 20 Dawson Wharf Mount
Subdivision Dawson's Landing
City Chestermere
Province Alberta
Postal Code T1X2Z5

Listing Details

Listing Office Century 21 Bravo Realty



The trademarks MLS®, Multiple Listing Service® and the associated logos are owned by The Canadian Real Estate Association (CREA) and identify the quality of services provided by real estate professionals who are members of CREA. REALTOR®. Member of CREA and more.

Listing information last updated on October 13th, 2025 at 7:01am CDT